

### ■ 訂購碼

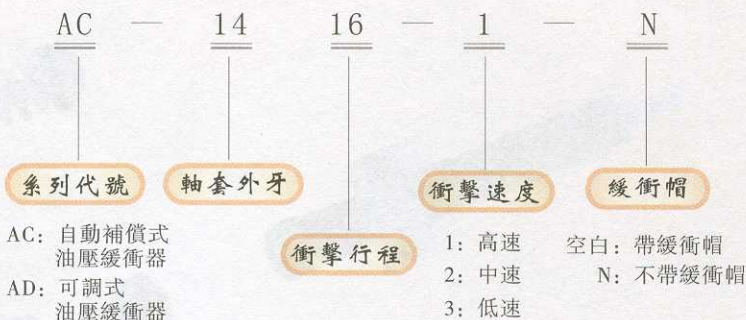

### 舉例

1) 欲訂購軸套外牙為M8，緩衝行程為6mm，衝擊速度為高速，不帶緩衝帽的自動補償式油壓緩衝器。其正確的訂購碼為：AC-0806-1-N。

2) 欲訂購軸套外牙為M14，緩衝行程為12mm，衝擊速度為中速，不帶緩衝帽的自動補償式油壓緩衝器。其正確的訂購碼為：AC-1412-2-N。

### ■ 產品規格

項目	行程 mm	最大吸收能量 Nm	小時吸收能量 Nm	最大有效重量 Kg			最高撞擊速度 m/s			工作溫度 ℃	重量 g
				1	2	3	1	2	3		
AC-0806	6	2	1200	0.5	2	6	2	1	0.5	-10-80	11
AC-1005	5	3	3600	1	3	7	3	1.5	0.8	-10-80	14
AC-1008	8	4	5000	2	4	9	3	1.5	0.8	-10-80	20
AC-1210	10	5	10,000	5	10	30	2	1.5	0.8	-10-80	31.5
AC-1412	12	15	30,000	8	50	100	3	1.5	0.8	-10-80	80
AC-1416	16	20	35,000	10	70	150	3	1.5	0.8	-10-80	90
AC-2020	20	40	40,000	30	200	700	3.5	2	1	-10-80	215
AC-2050	50	60	60,000	60	400	1200	3.5	2	1	-10-80	300
AC-2525	25	80	70,000	200	800	1500	4	2.5	1	-10-80	330
AC-2540	40	120	75,000	300	1200	2000	4	2.5	1	-10-80	430
AC-3660	60	250	120,000	400	1500	2400	4	2.5	1	-10-80	1030
AD-1410	10	20	25,000		80			3		-10-80	90
AD-2016	16	25	30,000		200			3.5		-10-80	230
AD-2525	25	85	70,000		400			3.5		-10-80	350
AD-2540	40	100	80,000		700			3.5		-10-80	455
AD-3650	50	300	100,000		1400			3		-10-80	1100
AD-4225	25	260	125,000		3000			3.5		-10-80	1280
AD-4250	50	500	150,000		4000			4.5		-10-80	1495
AD-4275	75	750	180,000		6000			4.5		-10-80	1710
AD-6450	50	12000	1500,000		12727			1.5		-10-80	4115
AD-64100	100	24,000	2000,000		18181			1.5		-10-80	5280
AD-64150	150	36,000	2500,000		23636			1.5		-10-80	6785

\* 1: AC-20以上均附緩衝帽

2: AD系列因為緩衝力量可自行調整，因此緩衝速度沒有區分。



### 外部尺寸

#### 不帶緩衝帽

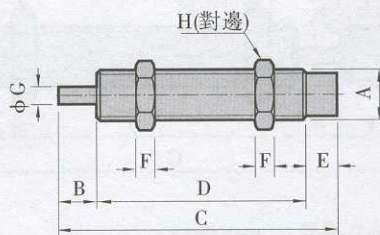

規格\符號	A	B	C	D	E	F	G	H
AC-0806	M8 × 1.0	6	44	33	5	3	2.8	11
AC-1005	M10 × 1.0	5	32.7	22.9	4.8	3	3	12.7
AC-1008	M10 × 1.0	8	51	38	5	3	3	12.7
AC-1210	M12 × 1.0	10	60	45.5	4.5	4	3	14
AC-1412	M14 × 1.5	12	88	67	9	6	4	19
AC-1416	M14 × 1.5	16	111	86	9	6	4	19

#### 帶緩衝帽

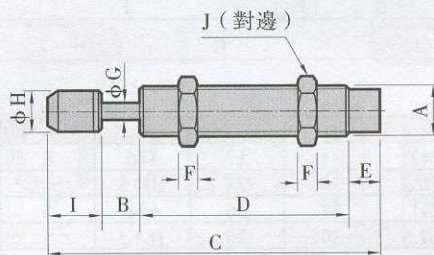

規格\符號	A	B	C	D	E	F	G	H	I	J
AC-0806	M8 × 1.0	6	52.4	33	5	3	2.8	6.6	8.4	11
AC-1005	M10 × 1.0	5	41.2	22.9	4.8	3	3	8.6	8.5	12.7
AC-1008	M10 × 1.0	8	59.5	38	5	3	3	8.6	8.5	12.7
AC-1210	M12 × 1.0	10	69.5	45.5	4.5	4	3	10.3	9.5	14
AC-1412	M14 × 1.5	12	102.5	67	9	6	4	12	14.5	19
AC-1416	M14 × 1.5	16	125.5	125.5	9	6	4	12	14.5	19
AC-2020	M20 × 1.5	20	146.5	146.5	9	8	6	18	16.5	26
AC-2050	M20 × 1.5	50	233.5	158	9	8	6	18	16.5	26
AC-2525	M25 × 1.5	25	154.3	101	10	10	8	22	18.3	32
AC-2540	M25 × 1.5	40	208.3	127	10	10	8	22	31.3	32
AC-3660	M36 × 1.5	60	243	134	11	15	10	35	21	46



# 油壓緩衝器

## AC\AD系列

可調式(AD)

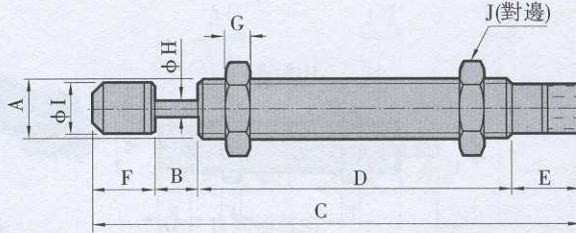

規格/符號	A	B	C	D	E	F	G	H	I	J
AD-1410	M14 × 1.5	10	113.5	73	16	14.5	6	4	12	19
AD-2016	M20 × 1.5	16	149.5	101	16	16.5	8	6	18	26
AD-2525	M25 × 1.5	25	161.8	101	17.5	18.3	10	8	22	32
AD-2540	M25 × 1.5	40	215.8	127	17.5	31.3	10	8	22	32

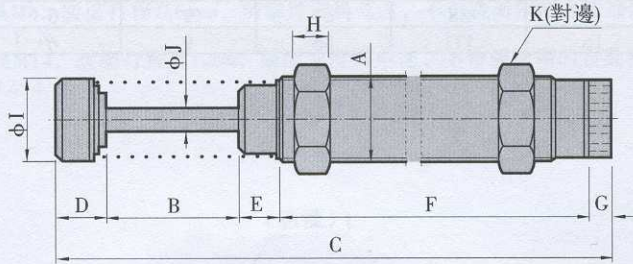

規格/符號	A	B	C	D	E	F	G	H	I	J	K
AD-3650	M36 × 1.5	50	242	21	17	146	8	15	35	10	46
AD-4225	M42 × 1.5	25	186.5	34	26	104.5	5	15	44.5	12	50
AD-4250	M42 × 1.5	50	241	34	26	134	5	15	44.5	12	50
AD-4275	M42 × 1.5	75	301.5	39	26	164.5	5	15	44.5	12	50

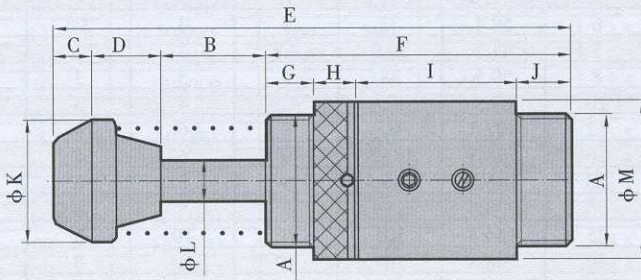

規格/符號	A	B	C	D	E	F	G	H	I	J	K	L
AD-6450	2 1/2-UNF(63.5)	50	18.8	33	247.8	146	23	20	77	26	59	20
AD-64100	2 1/2-UNF(63.5)	100	18.8	33	347.8	196	23	20	127	26	59	20
AD-64150	2 1/2-UNF(63.5)	150	18.8	43	467.8	256	23	20	187	26	59	20



### 訂購碼

SC — 12

系列代號

內牙規格

SC: 緩衝器定位螺帽

※ SC: M8~M36 F: M36~M42

### 使用實例

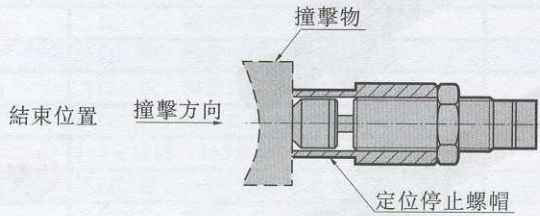
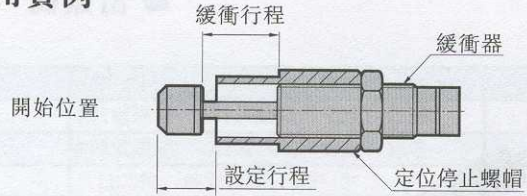

### 規格尺寸

SC-08

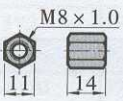

SC-10

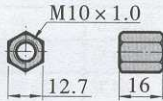

SC-12

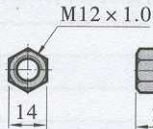

SC-14

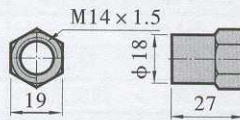

SC-20

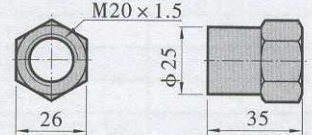

SC-25

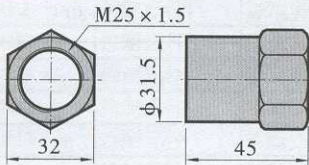

SC-40

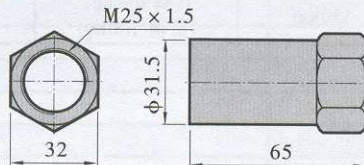

SC-50

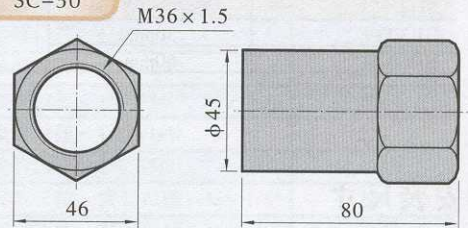

F36

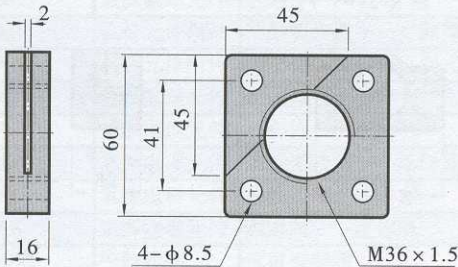

F42

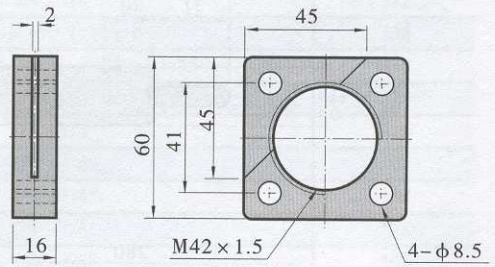

### 選用

編號	SC-08	SC-10	SC-12	SC-14	SC-20	SC-25	SC-40	SC-50	F36	F42
適用項目	AC-0806	AC-1005 AC-1008	AC-1210	AC-1412 AC-1416 AD-1410	AC-2020 ACD-2030 AC-2050 AD-2016	AC-2525 AD-2525	AC-2540 AD-2540	AC-3660 AD-3650	AC-3660 AD-3650	AD-4225 AD-4250 AD-4275